



INSTALLATION INSTRUCTIONS



ROC LOCK 2 REAR WIPER BLADE



1 Lift the car's rear wiper arm off the rear screen as far as it will go.



2 To remove the current wiper slowly rotate the wiper while pulling it away from the arm until it disengages.



3 To fit the new Ezywiper blade, align the centre of the connector's cross pin into the hook on the arm.

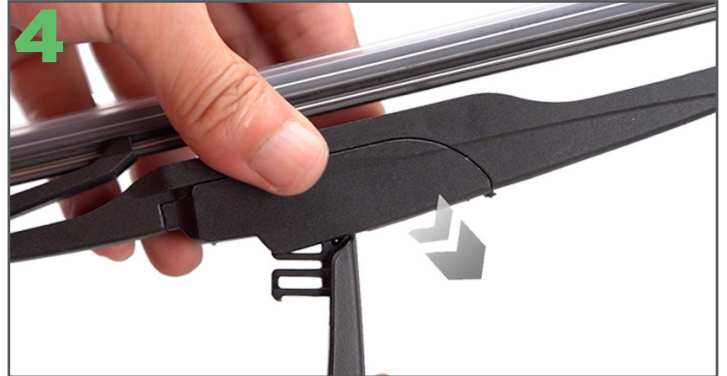

4 Push the blade down so the connector's cross pin fits into the hook on the arm.



5 Rotate the blade towards the arm until it locks into place.



6 Don't forget to remove the protective sleeve from the Ezywiper blade before placing the arm back on the rear screen.

For installation videos and more info see ezywiper.co.nz